

# M3 Sky Quick Manual

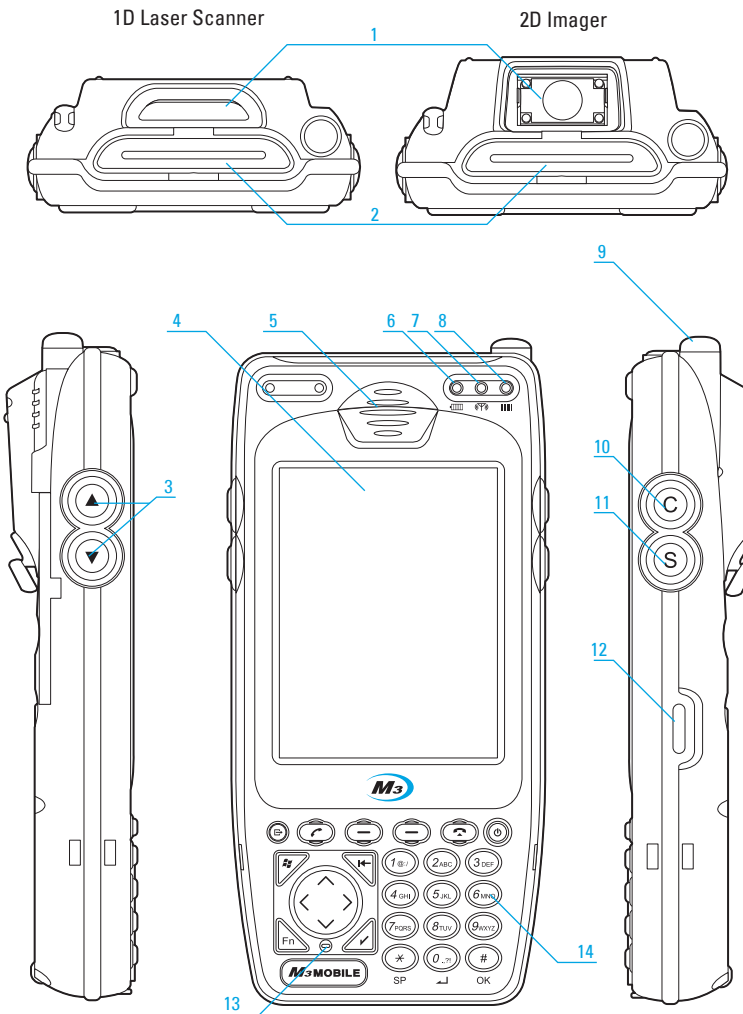

- 1 Barcode Scanner Window
- 2 Memory Card Cover
- 3 Up/Down Button
- 4 Touch Screen (with screen protector)
- 5 Speaker
- 6 Charging Status LED
- 7 Radio Status LED
- 8 Scan LED
- 9 Antenna
- 10 Camera Button
- 11 Scanner Button
- 12 Infrared Communication Port (IrDA)
- 13 Microphone
- 14 Keypad
- 15 24pin Connector (Alpha-numeric 24-pin connector)
- 16 I/O Connector
- 17 Stylus Pen
- 18 Camera Flash
- 19 Camera
- 20 Reset Switch
- 21 Battery Lock
- 22 Battery

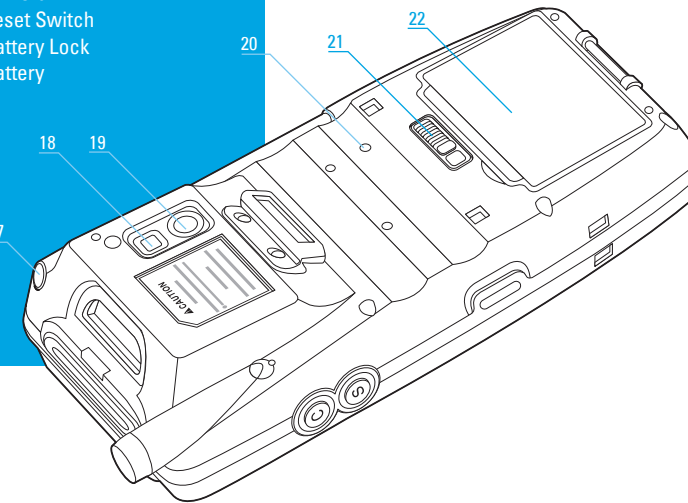
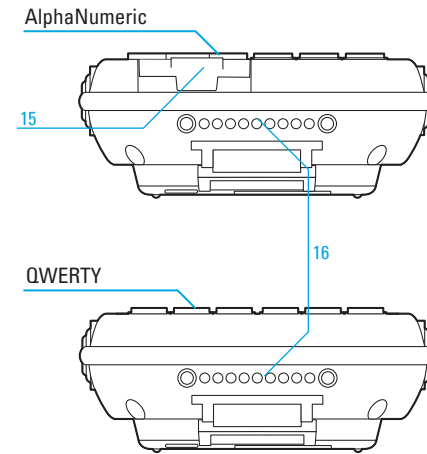

## RFID Design

### HF RFID (13.56MHz)

1D + RFID

2D + RFID

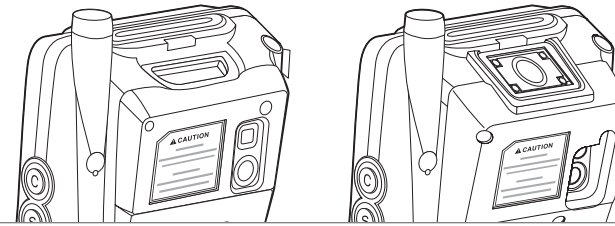

## Input Key

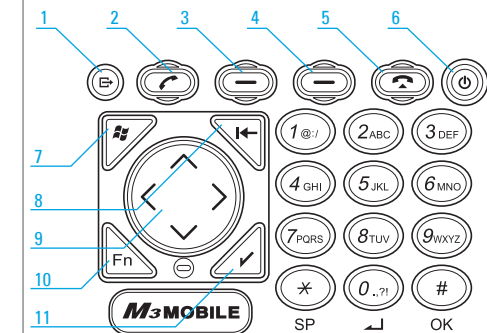

- 1 Alphanumeric
- 2 Talk
- 3 Left Soft Key
- 4 Right Soft Key
- 5 End
- 6 Power
- 7 Start
- 8 Backspace
- 9 Navigation
- 10 Function
- 11 Action

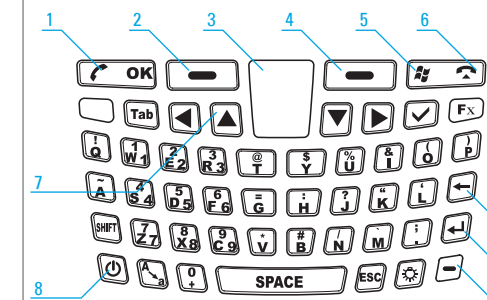

- 1 Talk
- 2 Left Soft Key
- 3 Scan Button
- 4 Right Soft Key
- 5 Start
- 6 End
- 7 Navigation
- 8 Power
- 9 Backspace
- 10 Enter
- 11 Microphone

⚠ Some Key functions might not be supported, depending on the option.

## Soft Reset

Soft reset makes your device to get a fresh start, similar to rebooting a computer.

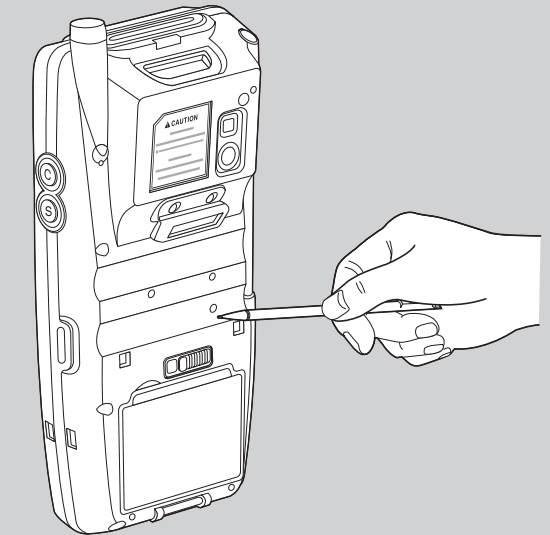

- ⚠ 1. In case that back-up battery is discharged completely, the device can not be booted by power button and soft-reset. Users are supposed to press the reset button for more than 5 seconds.
2. When the abnormal working (1.white screen 2. lock-up 3. etc) suddenly happen on the LCD display and the device can not be turned on by pressing power button. Please do soft reset.(Press the reset button with stylus pen.)
3. The device in sleep mode will be waken up when the device is put on cradle.



[sales@m3mobile.co.kr](mailto:sales@m3mobile.co.kr)  
[www.m3mobile.net](http://www.m3mobile.net)

#### HEADQUARTERS

135-923 M3 Bldg. 735-45  
Yeoksam-Dong, Gangnam-Gu,  
Seoul, Korea

Yeoksam-Dong, Gangnam-Gu,  
Seoul, Korea

T.+82-574-0037

#### M3 Factory

420-120, Chuneui-Technopark II,  
202 Chuneui-Dong, Wonmi-Gu,  
Bucheon, Korea

T. +82-32-623-0037

#### M3 R&D Center

135-923 Dongwon Bldg,  
725-30 Yeoksam-Dong,  
Gangnam-Gu, Seoul, Korea

T. +82-574-0037

copyright@m3mobile Corporation 2010 All Rights Reserved

## DEVICE SETUP

### SIM Card Installation

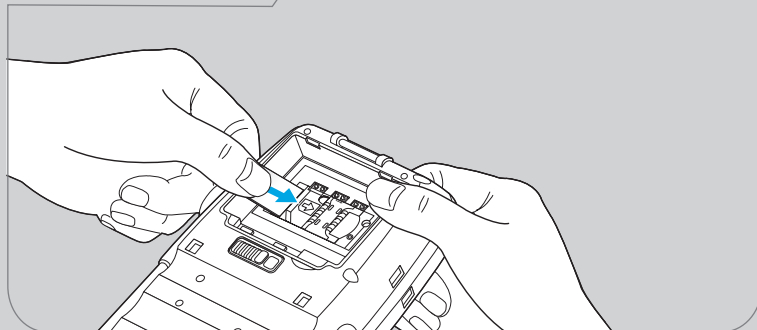

### Battery Installation

#### Insert the Battery

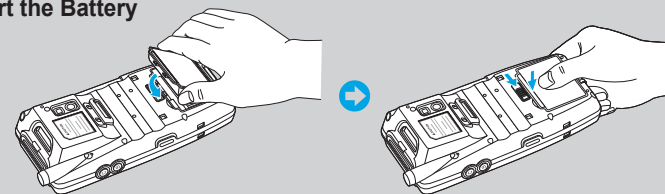

- Insert the battery, bottom first, into the battery compartment.
- Press down on the battery and fasten the battery lock.

#### Remove the Battery

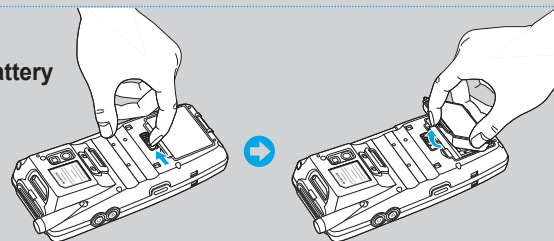

- Slide battery lock to the right. The battery ejects slightly.
- Grasp the battery and lift from the M3 SKY.

### Charging

#### Charge the M3 SKY & Battery

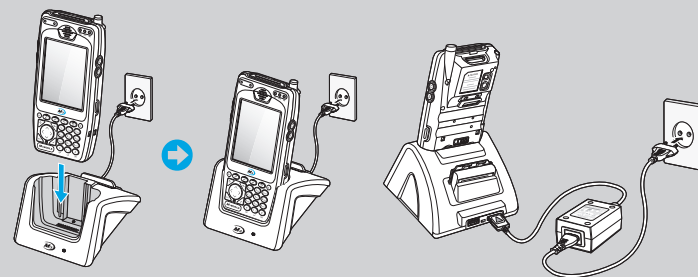

#### Charging with Portable adapter (Numeric keypad only)



### MiniSD Card Installation

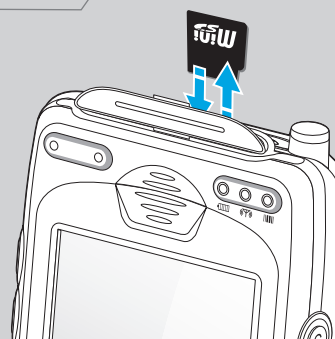

## DATA CAPTURE

### Scanning / Imaging

#### Scanning

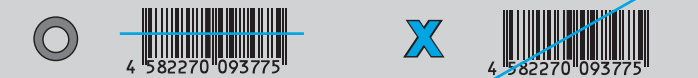

#### imaging



### RFID Reading

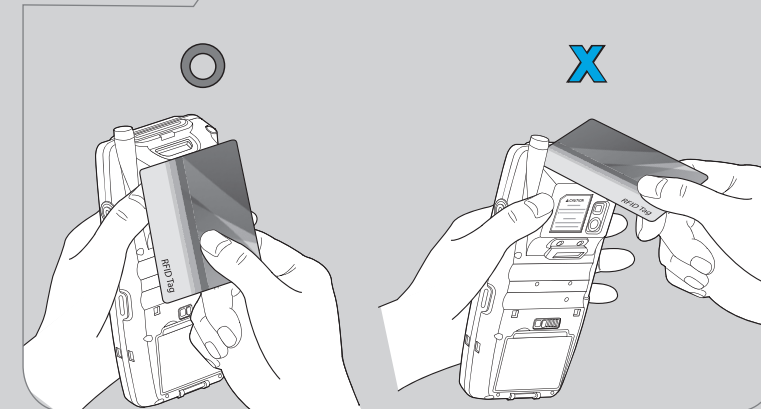

## ACCESSORIES

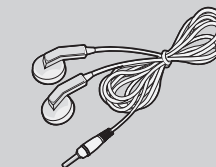

Ear Mic Phone

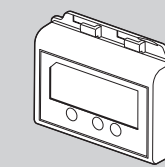

Battery

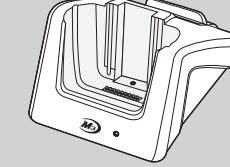

Cradle

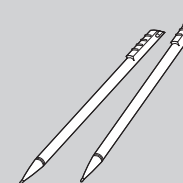

2 Units of Stylus



Quick Manual



Active Sync CD

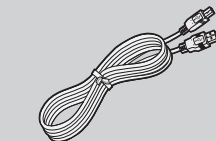

USB Cable

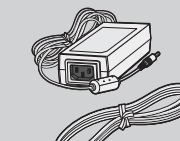

Portable Adapter