

M3 OX10

Quick Manual Ver.1.2



PACKAGE

- Please check all items below are included in package box.



< M3 OX10 >

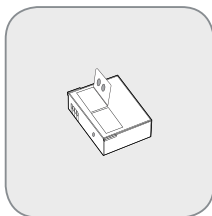

< Battery >

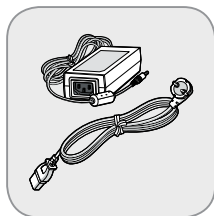

< Adaptor >

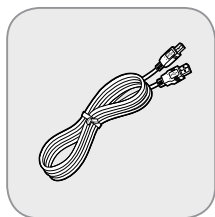

< USB cable >

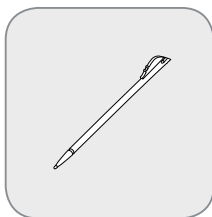

< Stylus pen >



< Cradle >

OR

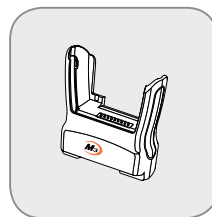

< Snap-on >

※ NOTE

For data synchronization, either desktop cradle or snap-on can be provided depending on your purchasing option.

※ Warning

Use of controls or adjustments or performance of procedures other than those specified herein may result in hazardous radiation exposure.

DEVICE

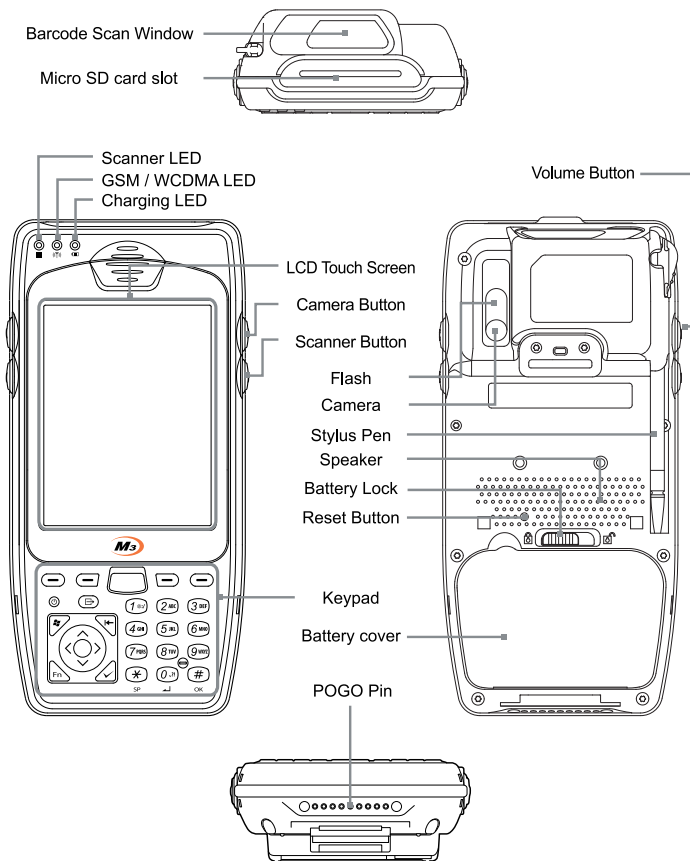

FEATURES

KEYPAD

- M3 OX10 has two types of keypad – Alphanumeric and QWERTY. Some function keys may not work depending on its options.

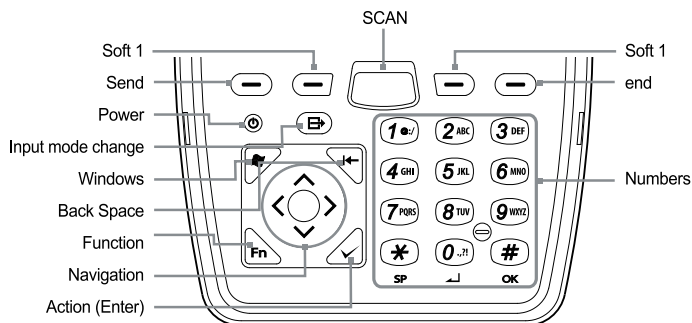

<AlphaNumeric>

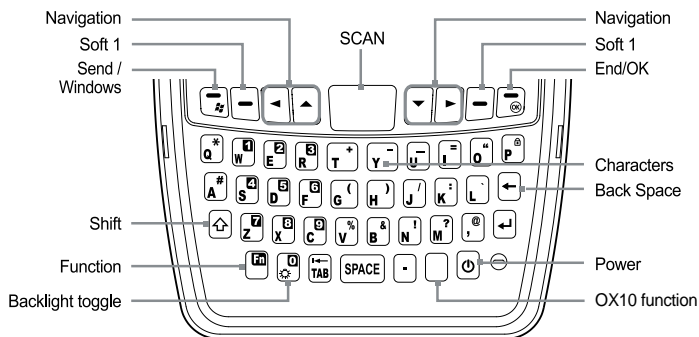

<QWERTY>

SOFT RESET

When an unexpected error occurs while using the device, SOFT RESET allows your device to restart, similar to rebooting a computer. It will adjust memory allocation - all records and entries are retained after soft reset but unsaved data or files may be lost.

- Press the RESET BUTTON briefly.

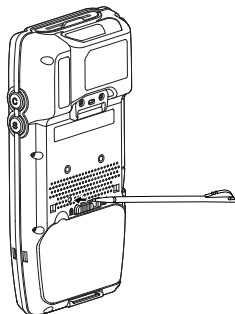

CLEAN BOOT

When an unexpected error cannot be solved with SOFT RESET, perform CLEAN BOOT to restart the system. It will erase all data stored in the device except in Flash Disk and return to its default settings.

Follow below steps to CLEAN BOOT. (> + Ⓞ or [] + Ⓞ)

- Press the POWER BUTTON more than 10 seconds.
- Press and hold the <RIGHT NAVIGATION> button then press the POWER button briefly.
- When Boot Menu will be displayed on the screen, press “3” to proceed CLEAN BOOT.

CARD INSTALLATION

USIM Card Installation

- Remove the battery from the battery pack.
- Insert the USIM Card as shown in the below picture.
- Insert the battery back to original position and lock by sliding the lock to secure position
- Check whether it is installed properly.

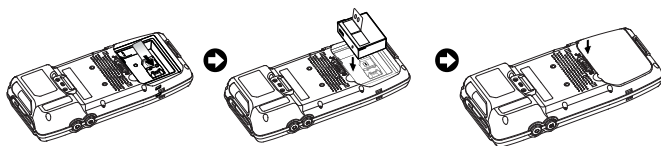

Micro SD Card Installation

- Open the memory card cover.
- Insert the Micro SD Card as shown in the left picture.
- Close the memory card cover back and check whether it is installed properly.

BATTERY

Inserting Battery

- Open battery cover by sliding the lock to the right.
- Insert the battery pack.
- Securely lock the battery cover by sliding the lock to the left.

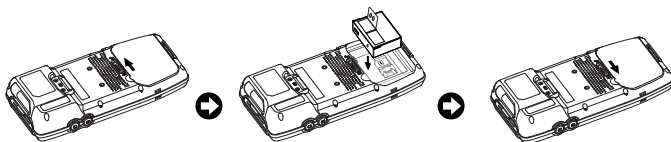

Removing Battery

- Loose the battery cover by sliding the lock to the right.
- Pull up the battery using the ribbon.
- Fasten the battery cover by sliding the lock to the left.

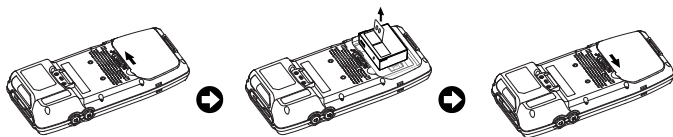

※ Warning

- Risk of Explosion if battery is replaced by an incorrect type. Dispose of used batteries according to the instructions.
- Battery contact pin can break if battery is forced to insert in wrong direction. Watch out for the correct direction as indicated on the battery.

CHARGING

※ Either Cradle or Snap-on will be provided.

How to charge

- Supply power to the cradle using the AC charger.
- Insert the PDA to device slot to start charging the PDA.

Charging status

Charging status of the PDA and the spare battery is indicated by LEDs.

LED charging indicator on the cradle indicates the charging status of the spare battery.

LED on upper left corner in the middle of the device indicates the charging status of the battery attached to the PDA.

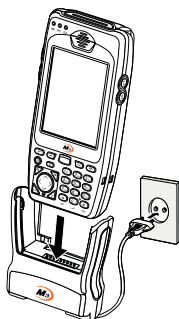
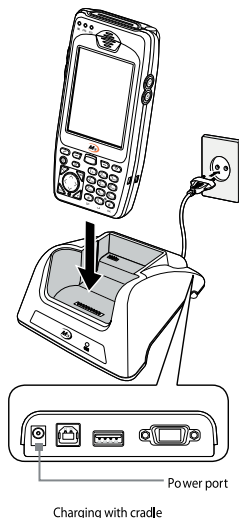

Charging with snap-on

LED Color	Battery Status
RED	The battery is being charged.
GREEN	The battery is fully charged.

※ Warning

- Risk of Explosion if unauthorized power supply is used.

SCANNER

Scanning

- Launch the Scanner program (either ScanEmul or M3ScanTest).
- Press the SCAN BUTTON toward barcode to read.

Make sure the laser beam covered whole barcode to read data properly.



O



X

Imaging

- Launch the Scanner program.
- Press the SCAN BUTTON toward barcode to read.

Make sure the laser beam covered whole barcode to read data properly.



O



X

※ Warning

LASER LIGHT - Do not stare into beam, CLASS 2 LASER PRODUCT
1.0mW, MAX OUTPUT:650nm

CAMERA

Taking pictures

- Run the Camera program.
- Tab the Capture button to take a picture.
- Taken pictures can be checked in the following folder.
For Windows Embedded Handheld: Start\Programs\Pictures&Videos
For Windows Embedded CE: \Flash Disk\Camera\Photo

Taking videos

- Run the Camera program.
- Tab the Video Mode button to take a video.
- Taken videos are stored in Pictures&Videos folder.
For Windows Embedded Handheld: Start\Programs\Pictures&Videos
Video feature is not supported in Windows Embedded CE

※ Warning

It may cause significant damage to your eyes if you directly look the flash attached at camera module.

SYNCHRONIZE with YOUR PC

Please download the ActiveSync from Microsoft webpage to activesync with PC.

ActiveSync :

[http://www.microsoft.com/downloads/en/details.](http://www.microsoft.com/downloads/en/details.aspx?FamilyID=9e641c34-6f7f-404d-a04b-dc09f8141141)

[aspx?FamilyID=9e641c34-6f7f-404d-a04b-dc09f8141141](http://www.microsoft.com/downloads/en/details.aspx?FamilyID=9e641c34-6f7f-404d-a04b-dc09f8141141)

Windows Mobile Device Center (Windows Vista and 7) :

[http://www.microsoft.com/windowsphone/en-us/howto/wp6/sync/
installing-wmdc.aspx](http://www.microsoft.com/windowsphone/en-us/howto/wp6/sync/installing-wmdc.aspx)

TECHNICAL SUPPORT

Should you require and services or technical support on M3 Mobile's product, contact your supplier or visit

M3 Information & Technology Center webpage on:

<http://itc.m3mobile.net>

After your enquiry is registered on the page, our professional engineer will reply to you within 24 hours in during the week.

For DOA or RMA, please send the defective product to suitable address AFTER consulting the supplier.

M3 MOBILE

Your Best Mobile Business Partner

Headquarter

M3 bldg., 14,
Teheran-ro 16-gil, Gangnam-gu,
Seoul, 135-923, Korea
Tel: +82 2 574 0037
Fax: +82 2 556 0155
www.m3mobile.net
sales@m3mobile.co.kr

Production Center/Service Center

Unit 610, 201
Chun-ui Techno Park, 18,
Bucheon-ro, 198beon-gil,
Wonmi-gu, Bucheon-si,
Gyeonggi-Do, 420-857, Korea
Tel: +82 32 623 0037
Fax: +82 70 4015 6323